

Contribute

The Magnolia 2,100 square feet 4 bedrooms with 2 bath a Reconstruction Solution 1 option for \$226,800



Published: 10-20-2018 Revised: 10-23-2018

Replacing your home with the Magnolia 2,100/sf home with 4 bedrooms and 2 bath is easy with Solution 1 from the Restore Homeowners Program. Just sign over a few documents, pay up your insurance and DOB and you are soon to be in your new home.

The Magnolia 2,100 SqFt cost estimate for Reconstruction Solution 1

Information is provided without warranty.

Homeowners in the Louisiana Restore Homeowners Program have made inquires to prices, size, styles of homes. The information on this page is based on official state policy published at the time of writing. Any changes to policy is the homeowners responsibility to research prior to executing any grant agreement with the state of Louisiana.

- Pricing is estimated based on current policy numbers of \$108/sf for labor and material with 20% overhead and profit.
- Listed is Solution 1 home style estimates
- Home is not actual design of home they will build. It appears based on the random selection of contractor provided by the program you will need to discuss the type and size of home with your Solution 1 builder. This page is only offering an estimate if the sqft were to match this home of what

you are allowed and listed in your grant award.

- Registered Sub-Contractors working with Innovative Emergency Management Inc (IEM Inc.) North Carolina and shown in the [states contract](#).
 - CORE Construction
 - Roy Anderson Corp.
 - Dynamic Construction Group
 - Design & Build Consultants
 - TKTMJ Inc.
- Your grant award must show Reconstruction and be converted before any hiring or work is started.
- All Insurance, ICC, NFIP, SBA, FEMA duplication of benefits creates Homeowners Responsibility on your part. I have only offered you calculations based on elevation that may change your additional costs. But as of this date showed in as page update the costs are still valid for grant awards.

*Note: Floor plan and home are only examples, builders will provide you with specific plans they have available in the selected square footage.

Variable: Demolish and removal of old home: \$10.00 square foot estimated

Variable: Elevation cost \$60.00 per square foot is an estimate.

Variable: Elevation height: 2' to 5' (included into \$108 price for pier and beam)

Fixed: Grant allowance \$108.00 per square foot for construction.

Fixed: 20% Contractor overhead and profit calculated separately.

Estimate: 2,100 square foot pre-flood home replaced with 2,100 square foot home post-flood.

- Grant / Cost allowance **\$226,800**
- Demolish / Removal 2,100 sqft home, cost: \$10.00 = \$21,000 (included in allowance)
 - -\$10.00 per square foot from reconstruction cost \$108/sf.
- Elevation 6' full pour or strap foundation with 4' column to beam 11.25" to joist 11.25" to sub-floor 3/4"
 - First 3 feet from strap footer or bottom of monolithic slab. Included in \$108 /sf.
 - Middle 0 foot column elevation costs calculated by [Table 1 Elevation](#). Applies when elevation is over 3 feet or 2 feet above grade. Multiply sqft of home by allocated amount from [Table 1 Elevation](#).
 - Last 2 feet beam, joist, sub-floor. Included in \$108/sf
- Running total of allowance / cost = \$226,800 + \$0 = \$226,800
- Calculation of old home size and grant award: \$108 * 2,100 = \$226,800
- Total new construction with elevation: \$226,800
- Homeowners Responsibility: \$226,800 - (\$226,800 + \$0) = \$0.00

TruckAndTools.com

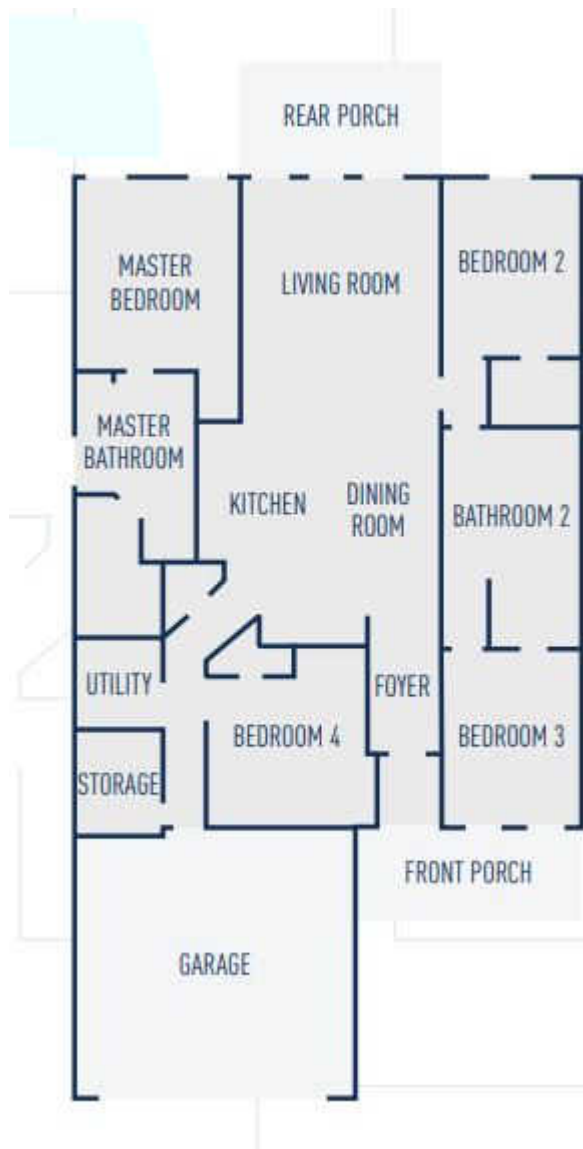

Elevation	850/sf	1100/sf	1300/sf	1400/sf	1700/sf	2100/sf
6'	\$36.63	\$33.90	\$32.81	\$33.27	\$30.87	\$28.35
9'	\$40.73	\$37.62	\$36.42	\$36.95	\$34.28	\$31.47



THE MAGNOLIA

4 BEDROOM,

Resources and Links

You will have one of the following residential licensed in the state of Louisiana contractors sub-contracting your new home construction if you select solution 1 from the [Restore LA Homeowners Assistance Program](#). Prices are from Homeowners Manual version 4.1 and approved by contract management company IEM Inc. of North Carolina for the State of Louisiana Office of Community Development - Disaster Recovery Unit and the HUD CDBG-DR program. Find the official pricing policy linked [here for the Restore Louisiana Homeowners Assistance program](#).

- State Program Agency: OCD-DRU Louisiana aka Restore LA Homeowners Program (RLHP)
- IEM Inc. Management Contractor for OCD-DRU
- Sub-Contractors List working for IEM Inc. Reconstruction, Remodel, Repair services for Solution 1 homeowners.
 - CORE Construction
 - Roy Anderson Corp. (Subs)
 - Dynamic Construction Group. (Subs)
 - Design & Build Consultants
 - TKTMJ Inc.
- Many contractors sub-contracts out to home builders. We are preparing a list of Contractors that are not involved in the actual building so if you are using Solution 2 Managed you will be able to contact the actual builder to remove the middleman and award the full Overhead and Profit to the Home

Builder.

Restore LA Homeowners Program Solution 1 homes linked.

- [The Live Oak 2,102sqft \\$227,016](#)
- [The Magnolia 2,100sqft \\$227,800](#)
- [The Willow 1,702sqft \\$183,816](#)
- [The Pelican 1,680sqft \\$181,440](#)
- [The Dogwood 1,500sqft \\$162,000](#)
- [The Brookmont 1,421sqft \\$153,468](#)
- [The Lilly 1,297sqft \\$140,076](#)
- [The Cypress 1,260sqft \\$136,080](#)
- [The Rose 1,074sqft \\$115,992](#)
- [The Daisy 856sqft \\$92,448](#)

Copy provided by TruckAndTools.Com developed by Murray Wennerlund.

Email help@truckandtools.com for additional information.

Copyright © 2019 TruckAndTools.Com All Rights Reserved.

Original location: <https://www.truckandtools.com/disaster/bureaucracy.asp?gdyk=167>

Published: 10-20-2018 Revised: 10-23-2018

[Contribute](#)

**TRUCK AND
TOOLS .COM**

TruckAndTools.Com